

DONGXU HYDRAULICS

Over 1,000,000 units sold 6,000+ customers served
Product lifespan of up to 10 years

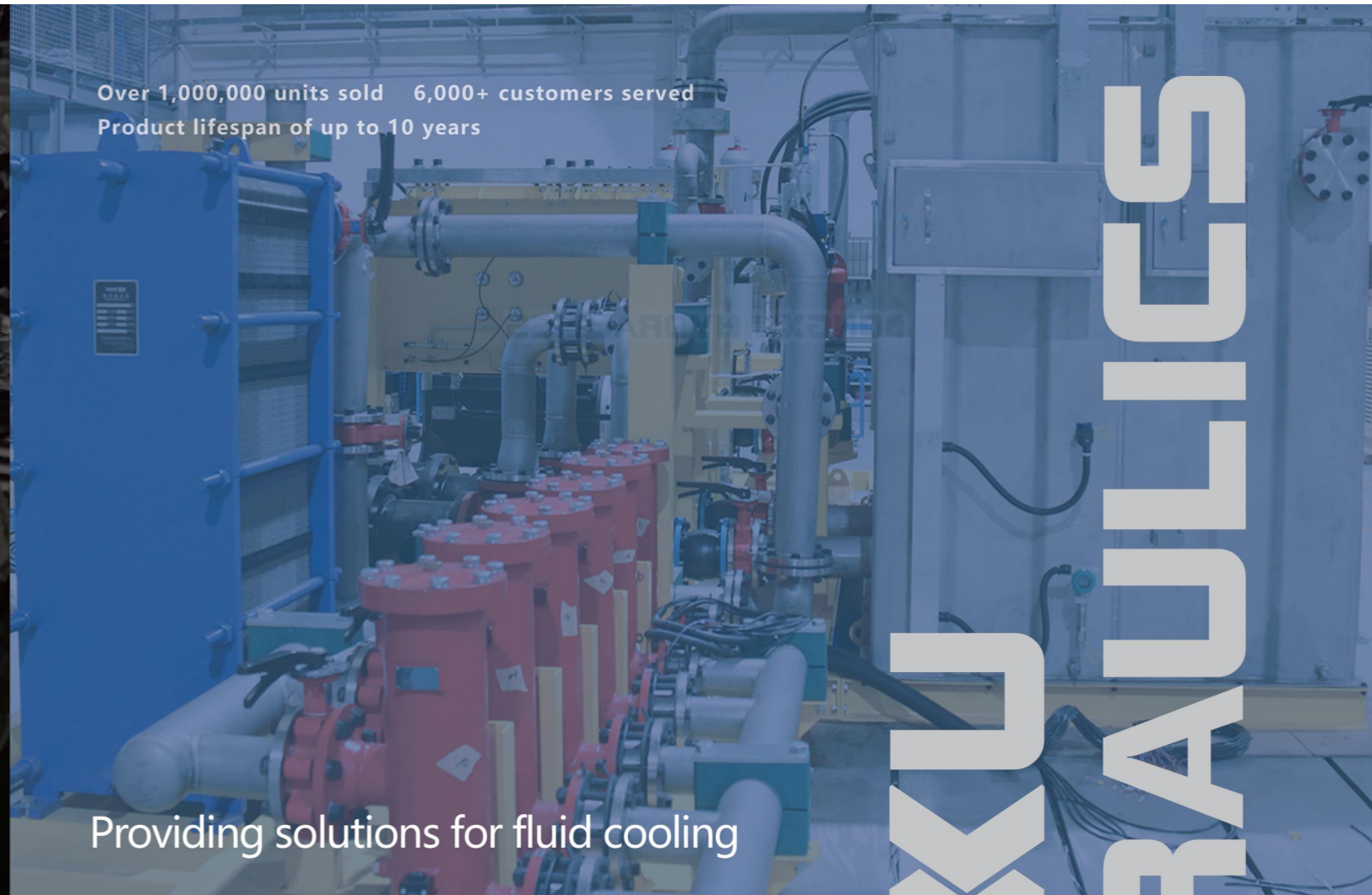

Providing solutions for fluid cooling



WhatsApp



Web

Dongxu Guangdong Company

Add.: C3 New Light Source Park, Foshan, Guangdong, China
Tel: 400 8779122
E-mail: hannah@dongxuhydraulics.com
WhatsApp: +86 139 2992 3909
Web: www.dongxuyeya.com

Dongxu Jiangsu Company

Add.: Build.77, No.288 HubinNorth Road, Wuxi, Jiangsu, China
Tel: 400 8776122
E-mail: hannah@fsdxyy.com
WhatsApp: +86 139 2992 3909
Web: www.jshlk.com

Dongxu Europe Company

Add.: Vogelsanger Weg 91 40470 Duesseldorf Germany
Tel: 0049 211 2204 4607
E-Mail: europa@dxhydraulics.com
WhatsApp: +49 177 6970 861
Web: www.dxhydraulics.com



Dongxu Hydraulic Machinery Co., Ltd.



ISO9001



DONGXU HYDRAULICS





COMPANY PROFILE

Dongxu Hydraulic Machinery Co., Ltd. ("Dongxu Hydraulics") , founded in 2002, we are a pioneering company specializing in research, development, and manufacturing, with a primary focus on fluid temperature control for industrial equipment, hydraulic lubrication fluid control systems, and hydraulic components.

With a diverse portfolio of products, we serve a wide range of industries, including new energy, energy storage, semiconductor, data centers, power equipment, metallurgy, forging, construction machinery, electrical machinery, petrochemicals, machine tool industry, offshore vessels, mining machinery, papermaking machinery, industrial automation control, and intelligent manufacturing. With an unwavering commitment to quality, our market presence spans nationwide and extends to Europe, Southeast Asia, and North America, making us a strategic partner for renowned domestic and international enterprises.

At Dongxu Hydraulics, we attribute our success to our relentless pursuit of innovation and development. To achieve this, we have established a dedicated R&D team comprising exceptional technical talents from both domestic and international backgrounds. Collaborating with prestigious institutions such as Zhejiang University, South China University of Technology, Tsinghua University, Yanshan University, and Yangzhou University, we leverage practical technology, emerging technology, and service technology as the foundation for our research and development efforts. Currently, we have successfully transformed over sixty patented achievements, constantly driving our company's growth through sustained innovation.

To cater to the evolving needs of our customers, we have established production and R&D centers in Foshan, Chengdu, and Wuxi. Complemented by an extensive after-sales and service network, we ensure comprehensive coverage across both domestic and select international markets. Our commitment to excellence has been recognized through prestigious accolades, including Provincial-level Specialized, Focused, New and High-tech Enterprise , National-level High-tech Enterprise , Chairman Unit of Foshan Hydraulic and Pneumatic Industry Association, as well as Innovative Small and Medium-sized Enterprise. Furthermore, we have obtained certifications such as ISO 9001 (quality management), ISO 4001 (environmental management), ISO 10012 (measurement management), GB/T 29490-2013 (intellectual property management), and CE (EU export).

Driven by our vision to " Create a national brand for Chinese manufacturing", while placing customer satisfaction at the core of our operations, we strive to become a trusted and admired brand enterprise, continuously pushing the boundaries of innovation with our intelligence and creative spirit. Our ultimate goal is to be the preferred partner for global machinery and equipment providers.



Provincial Specialized, Focused, New and High-tech Enterprise



Provincial High-tech Enterprise



CE European Safety Compliance



ISO10012 Measurement Management System Certification

Vision

To create a national brand made in China, to become a brand enterprise trusted and loved by users, to be a high-growth enterprise with sustainable operation, and to be a company with a sense of social responsibility

Service Philosophy

Our service philosophy is to keenly grasp application trends, promptly meet customer needs, pursue excellence, provide high-quality products, prioritize customer-centricity, and exceed customer satisfaction.

Core Values

Our service philosophy is to keenly grasp application trends, promptly meet customer needs, pursue excellence, provide high-quality products, prioritize customer-centricity, and exceed customer satisfaction.

Business Philosophy

Our business philosophy is built on integrity and loyalty, placing customers first, focusing on expertise, aligning goals, emphasizing quality, and fostering continuous innovation.

Team Spirit

Our team spirit is characterized by diligence and dedication, honesty and integrity, courage and loyalty, optimism and confidence, a passion for learning, proactive advancement, innovation and contribution, a strong focus on cooperation, and an ownership mentality

Subsidiary brands



ENTERPRISE HONOR

The company strictly complies with the ISO9001:2015 quality management system and has formulated the "ISO9001:2015" Quality to provide stringent control over high-quality products.



Intellectual Property Management System Certification



ISO9001 Quality Management System Certification



ISO14001 Environmental Management System Certification



ISO10012 Measurement Management System Certification



CE European Safety Compliance Certificate



CE European Safety Compliance Certificate



Appearance Design Patent Certificate



Utility Model Patent Certificate

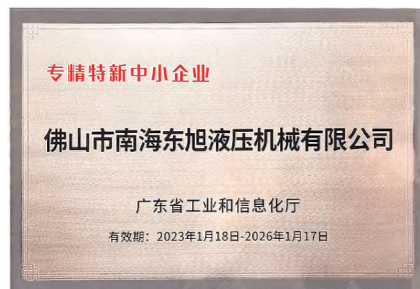

Provincial Specialized, Focused, New and High-tech Enterprise



Provincial High-tech Enterprise



Municipal Specialized, Focused, New and High-tech Enterprise



National-level Technology-based Small and Medium-sized Enterprise

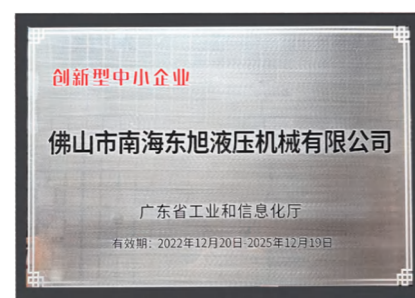

Innovative Small and Medium-sized Enterprise



Chairing unit of the Foshan Hydraulic Pneumatic Industry Association

Brazed plate heat exchanger

Customized products are available upon request



Product structure

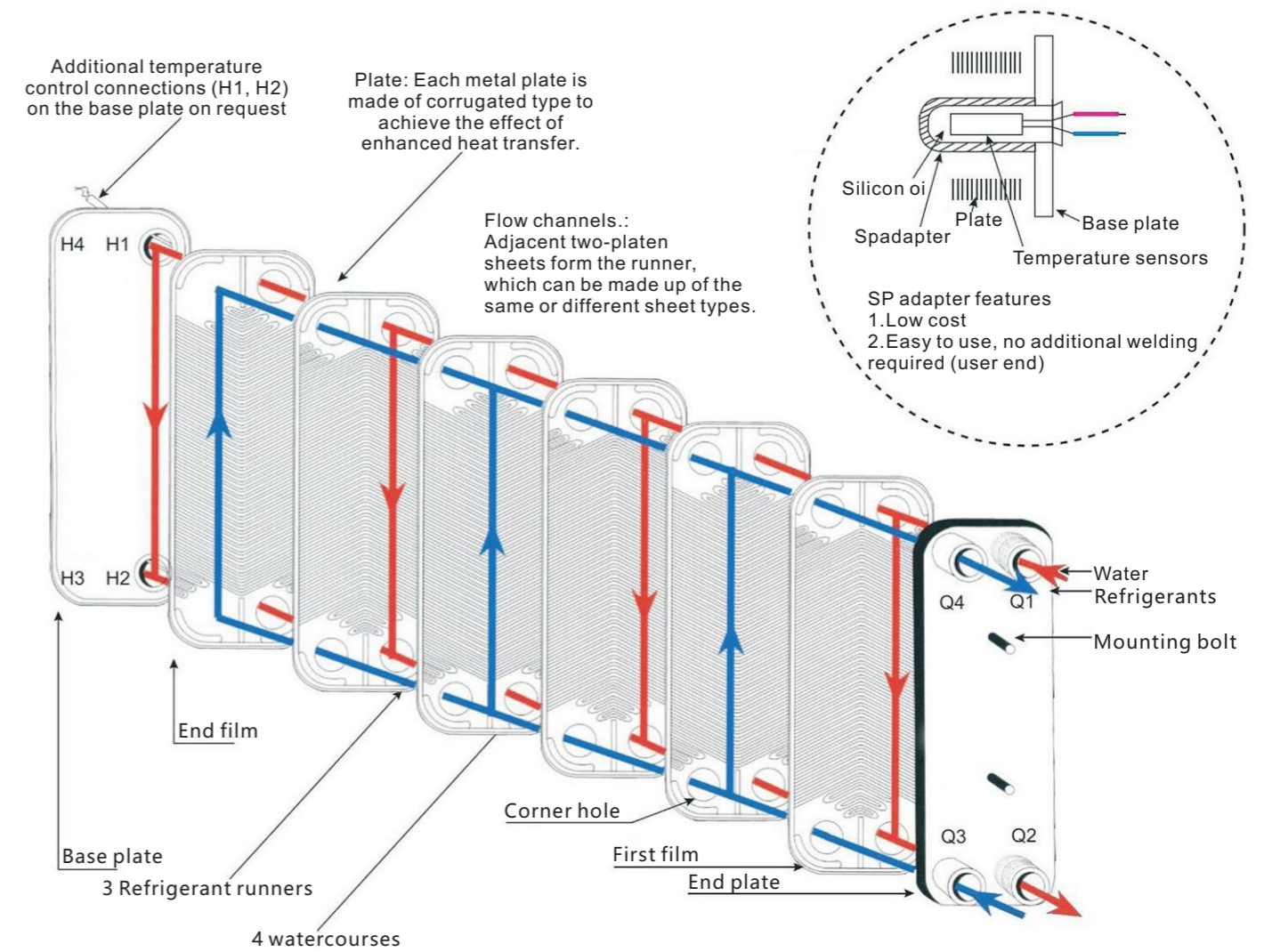

Brazed plate heat exchanger applicable media

- * Various refrigerants other than ammonia and chlorine
- * Water, water vapour
- * Oil
- * Organic solvents
- * Gases

Areas of application

Chemical industry

Concentrated Sulphuric Acid Cooler
 Manufacture of titanium oxide
 Cooling formaldehyde water
 Thermal phosphoric acid
 Ionic membrane caustic soda
 Manganese nitrate production unit
 Dilute acid cooler
 Ammonia synthesis
 Electrolysis alkali production
 Formaldehyde production line
 Soda ash
 Drying tower cooler

Food industry

Salt
 Dairy
 Juice Concentrate Cooler
 Gelatin concentration, sterilisation, cooling
 Soy sauce, vinegar sterilisation, cooling
 Animal and vegetable oil heating, cooling
 Heating and cooling of beer in beer production
 Alcohol saccharification, liquefaction, fermentation, distillation
 Honey cooler
 Edible alcohol mash

Mechanical engineering

Cooling of various quenching liquids
 Cooling quenching oil
 Cooling electroplating fluid
 Cooling reducer lubricant
 Cooling mill, wire drawing machine coolant

Non-Ferrous Metallurgy

Heating and Cooling of Aluminate Masterbatch
 Cooling of copper sulphate electrolyte
 Cooling of sodium aluminate solutions
 Alumina concentrate cooling
 Aluminium refining mill lubricant cooling

Paper industry

Cooling aqueous sodium hydroxide
 Heating and cooling of saline solution for bleaching
 Heat recovery of cellophane waste liquid
 Heating cooking acid
 Pre-heating of waste liquid for pulp thickening

Glass, cement and other industries

Textile industry

Oil and grease industry

Nuclear Thermoelectricity

Chilled water cooler
 Spent fuel pool cooler
 Diesel generator cooler
 Cryogenic nuclear heating
 Transformer oil cooler

Shipbuilding industry

Diesel engine cooling
 Cylinder liner water cooler
 Lubricating oil cooler
 Central cooler
 Preheater



Pharmaceutical industry

Forms of process combinations

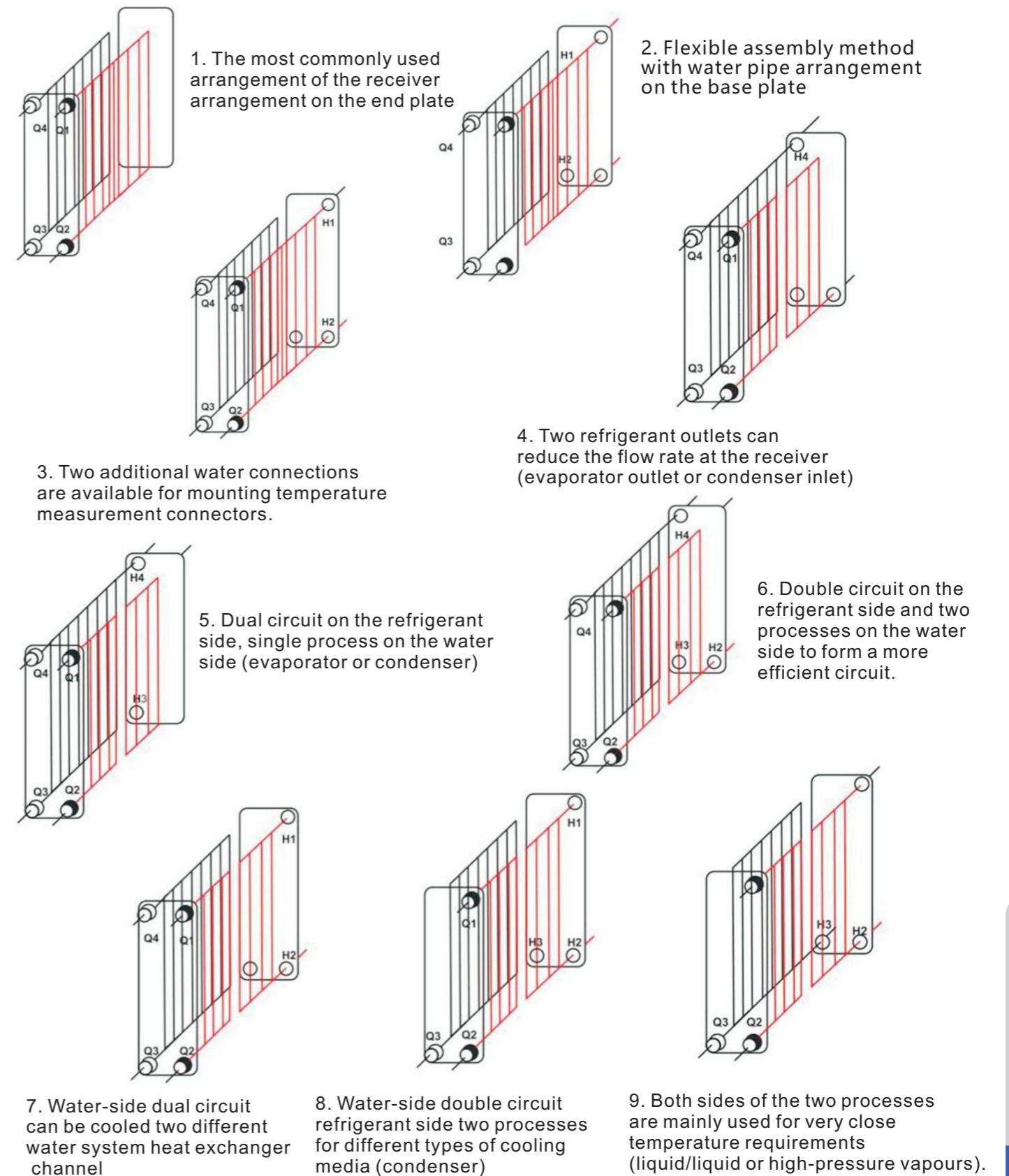

Channel combination form



D-Channel



H-Channel

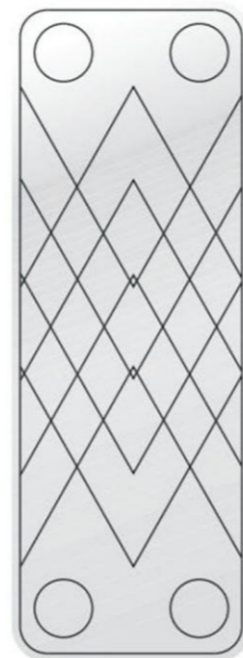

X-Channel

Heat exchanger passages

D-channel: channel consisting of adjacent plates with large angles

H-channel: channel consisting of a mixture of adjacent large/small angle plates.

X-channel: a channel consisting of adjacent plates with small corners.

Product Features :

Channel D: High heat transfer coefficient, high resistance. Suitable for small flow but strong heat transfer (high specific heat, phase change or large temperature difference), such as: refrigerant phase change heat transfer.

H-channel: between D-channel and X-channel.

X-channel: low heat transfer coefficient, low resistance. Suitable for large flow rate, weak heat transfer (low specific heat or small temperature difference), such as: air heat transfer under ambient pressure.

Plate heat exchanger selection

As a non-standard piece of equipment, plate heat exchangers are professionally designed, selected, and manufactured on your actual usage requirements. We need you to provide the following parameters.

Information on the necessary parameters for the selection of conventional heat exchangers

| Heat exchange: | kW | Design Pressure Requirements | ≥ | Mpa |
|-------------------------------------|----|---|---|-----|
| Required Product Type Selection: | | <input type="checkbox"/> Brazed plate heat exchanger () <input type="checkbox"/> Detachable plate heat exchanger () | | |
| Hot side | | Cold side | | |
| Fluid name : | | Liquid name : | | |
| Inlet temperature : | | °C | | |
| Outlet temperature : | | °C | | |
| Work mass flow rate : | | m ³ /h | | |
| Pressure drop design requirements : | | ≥ KPA | | |
| Receiver Requirement Type : | | | | |
| Inlet Pipe Size : | | | | |
| Outlet Pipe Size : | | | | |

If a brazed plate heat exchanger is required

| | |
|--|--|
| Are mounting bolts required: Yes () No () | Does it require a fixing bracket: Yes () No () |
| Whether a thermowell is required: Yes () No () | Temperature measurement tube installation position: Yes () No () |

Other technical requirements

Special note:

- 1、 If it is non-conventional work material, please be sure to provide the specific heat and viscosity, density, thermal conductivity of the work material at three temperatures; if it is mixed work material, please be sure to provide the composition of the work material and the proportion of the components. If it is a mixed work material, please be sure to provide the composition of the work material and the proportion of each component.
- 2、 Please be sure to provide the working pressure and allowable pressure loss, if you can't provide, We will perform calculations based on an allowable pressure loss of 100 KPA.
- 3、 we design and select the type according to the above parameters provided by the customer, and the accuracy of the design results and the effectiveness of the product depends on the degree of accuracy of the data provided by the customer.

Evaporator Selection

| Cooling capacity: | kW | Design Pressure Requirements | ≥ | Mpa |
|-------------------------------------|----|------------------------------|---|-----|
| Hot side | | Cold side | | |
| Fluid name : | | Refrigerant name : | | |
| Inlet temperature : | °C | Evaporation temperature : | | °C |
| Outlet temperature : | °C | Overheating : | | °C |
| Work mass flow rate : | | m ³ /h | | |
| Pressure drop design requirements : | ≥ | KPA | | |
| Receiver Requirement Type : | | | | |
| Inlet Pipe Size : | | | | |
| Outlet Pipe Size : | | | | |

Accessory Configuration Requirements

| | |
|--|--|
| Are mounting bolts required: Yes () No () | Does it require a fixing bracket: Yes () No () |
| Whether a thermowell is required: Yes () No () | Temperature measurement tube installation position: Yes () No () |

Other technical requirements

Condenser Selection

| Calorific value: | kW | Design Pressure Requirements | ≥ | Mpa |
|-------------------------------------|----|------------------------------|---|-----|
| Hot side | | Cold side | | |
| Fluid name : | | | | |
| Inlet temperature : | °C | Condensing temperature : | | °C |
| Outlet temperature : | °C | Subcooling temperature : | | °C |
| Work mass flow rate : | | m ³ /h | | |
| Pressure drop design requirements : | ≥ | KPA | | |
| Receiver Requirement Type : | | | | |
| Inlet Pipe Size : | | | | |
| Outlet Pipe Size : | | | | |

Accessory Configuration Requirements

| | |
|--|--|
| Are mounting bolts required: Yes () No () | Does it require a fixing bracket: Yes () No () |
| Whether a thermowell is required: Yes () No () | Temperature measurement tube installation position: Yes () No () |

Other technical requirements

Model Naming

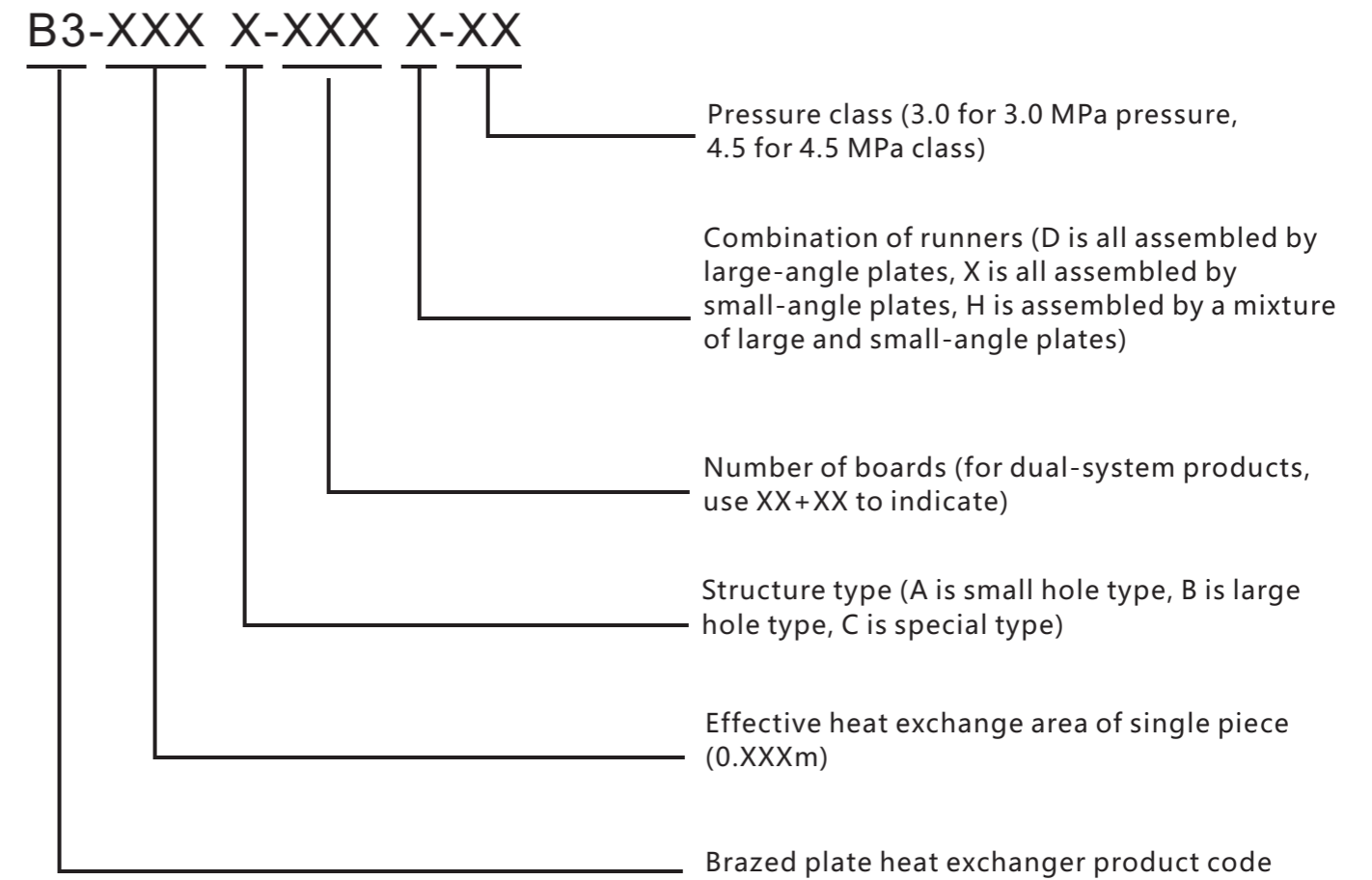

Brazed plate heat exchanger

B3-014 Models

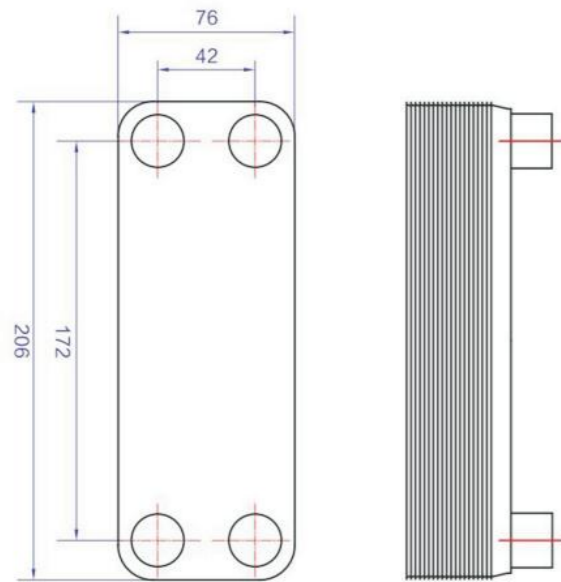

(N is the number of plates)

| | |
|---|------------|
| Single piece heat exchange area (m ²) | 0.014 |
| Design Pressure (Mpa) | 3.0/4.5 |
| Test pressure (Mpa) | 4.5/6.5 |
| Power range (mm) | 9+2.3N |
| Effective heat transfer area (m ²) | 0.014(N-2) |
| Design temperature (°C) | -100/+200 |
| Channel Type | D |
| Optional materials for plates | 304, 316L |
| Maximum number of assembled pieces | 80 |
| Maximum interface | DN20 |

Note: Non-standard interface, please contact our technical department.

B3-020 Models

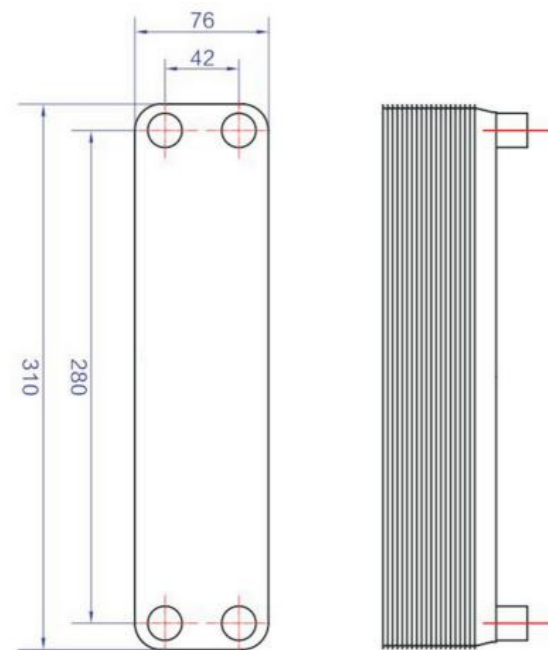

(N is the number of plates)

| | |
|---|-----------|
| Single piece heat exchange area (m ²) | 0.02 |
| Design Pressure (Mpa) | 3.0/4.5 |
| Test pressure (Mpa) | 4.5/6.5 |
| Power range (mm) | 9+2.3N |
| Effective heat transfer area (m ²) | 0.02(N-2) |
| Design temperature (°C) | -100/+200 |
| Channel Type | D |
| Optional materials for plates | 304, 316L |
| Maximum number of assembled pieces | 100 |
| Maximum interface | DN20 |

Note: Non-standard interface, please contact our technical department.

Brazed plate heat exchanger

B3-026 Models

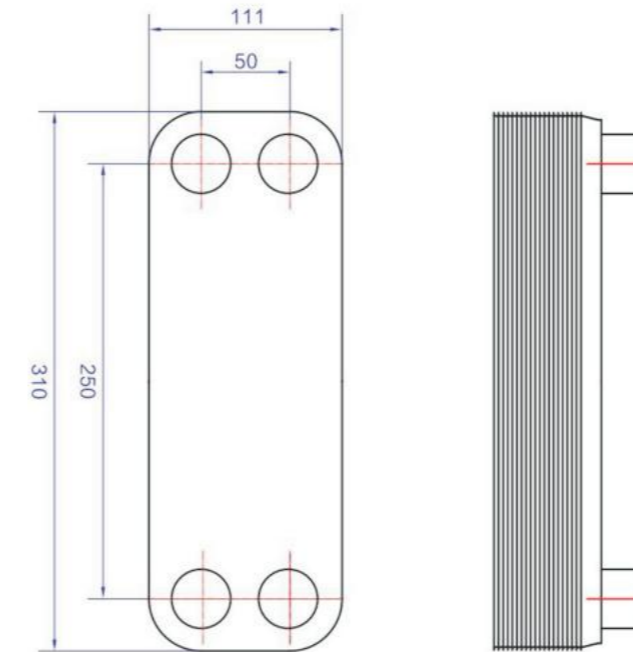

(N is the number of plates)

| | |
|---|------------|
| Single piece heat exchange area (m ²) | 0.026 |
| Design Pressure (Mpa) | 3.0/4.5 |
| Test pressure (Mpa) | 4.5/6.5 |
| Power range (mm) | 9+2.3N |
| Effective heat transfer area (m ²) | 0.026(N-2) |
| Design temperature (°C) | -100/+200 |
| Channel Type | D, X, H |
| Optional materials for plates | 304, 316L |
| Maximum number of assembled pieces | 150 |
| Maximum interface | DN40 |

Note: Non-standard interface, please contact our technical department.

B3-028 Models

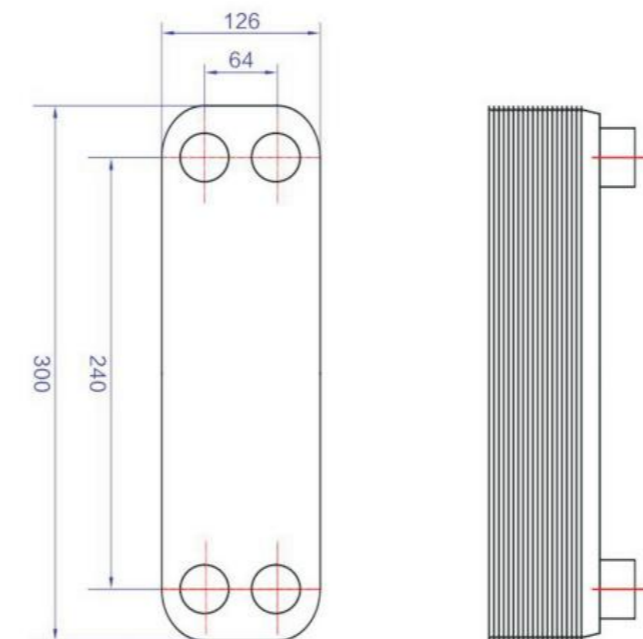

(N is the number of plates)

| | |
|---|------------|
| Single piece heat exchange area (m ²) | 0.028 |
| Design Pressure (Mpa) | 3.0/4.5 |
| Test pressure (Mpa) | 4.5/6.5 |
| Power range (mm) | 9+2.3N |
| Effective heat transfer area (m ²) | 0.028(N-2) |
| Design temperature (°C) | -100/+200 |
| Channel Type | D |
| Optional materials for plates | 304, 316L |
| Maximum number of assembled pieces | 150 |
| Maximum interface | DN40 |

Note: Non-standard interface, please contact our technical department.

Brazed plate heat exchanger

B3-050 Models

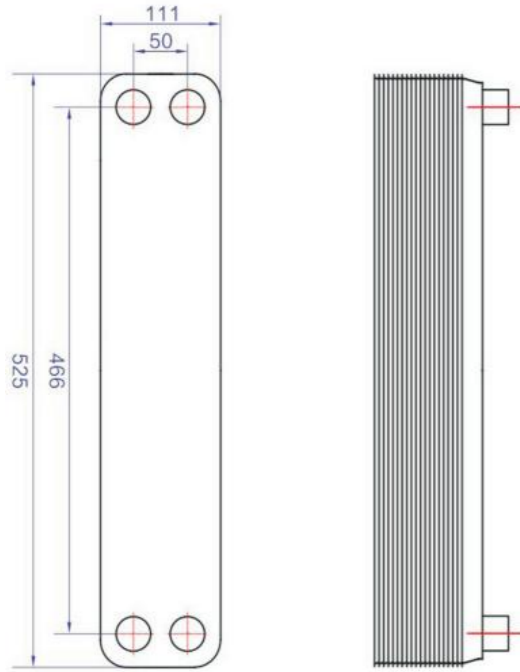

(N is the number of plates)

| | |
|---|-----------|
| Single piece heat exchange area (m ²) | 0.05 |
| Design Pressure (Mpa) | 3.0/4.5 |
| Test pressure (Mpa) | 4.5/6.5 |
| Power range (mm) | 9+2.4N |
| Effective heat transfer area (m ²) | 0.05(N-2) |
| Design temperature (°C) | -100/+200 |
| Channel Type | D、X、H |
| Optional materials for plates | 304、316L |
| Maximum number of assembled pieces | 150 |
| Maximum interface | DN40 |

Note: Non-standard interface, please contact our technical department.

B3-060 Models

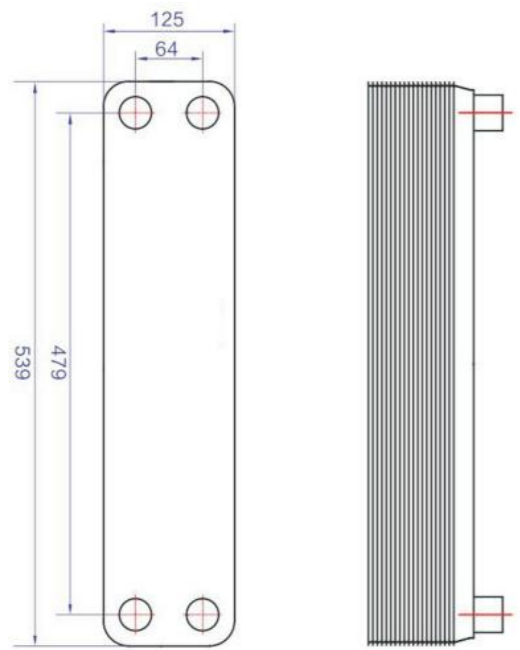

(N is the number of plates)

| | |
|---|-----------|
| Single piece heat exchange area (m ²) | 0.06 |
| Design Pressure (Mpa) | 3.0/4.5 |
| Test pressure (Mpa) | 4.5/6.5 |
| Power range (mm) | 9+2.4N |
| Effective heat transfer area (m ²) | 0.06(N-2) |
| Design temperature (°C) | -100/+200 |
| Channel Type | D |
| Optional materials for plates | 304、316L |
| Maximum number of assembled pieces | 150 |
| Maximum interface | DN40 |

Note: Non-standard interface, please contact our technical department.

Brazed plate heat exchanger

B3-095 Models

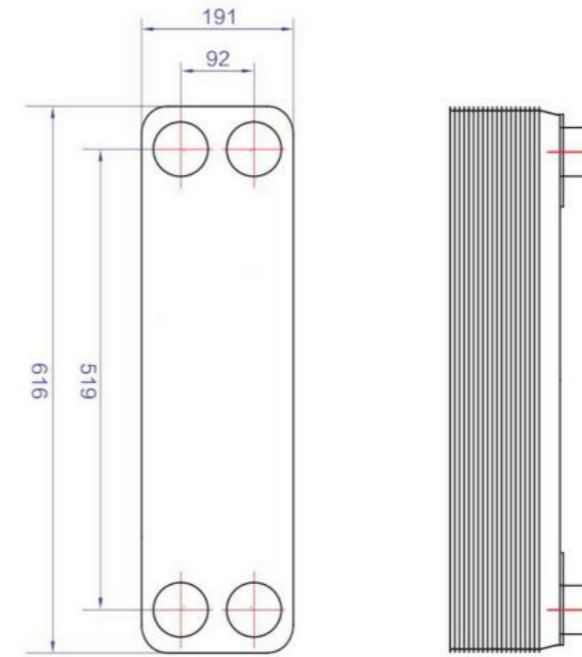

(N is the number of plates)

| | |
|---|------------|
| Single piece heat exchange area (m ²) | 0.095 |
| Design Pressure (Mpa) | 3.0/4.5 |
| Test pressure (Mpa) | 4.5/6.5 |
| Power range (mm) | 11+2.8N |
| Effective heat transfer area (m ²) | 0.095(N-2) |
| Design temperature (°C) | -100/+200 |
| Channel Type | D、X、H |
| Optional materials for plates | 304、316L |
| Maximum number of assembled pieces | 240 |
| Maximum interface | DN50 |

Note: Non-standard interface, please contact our technical department.

B3-110 Models

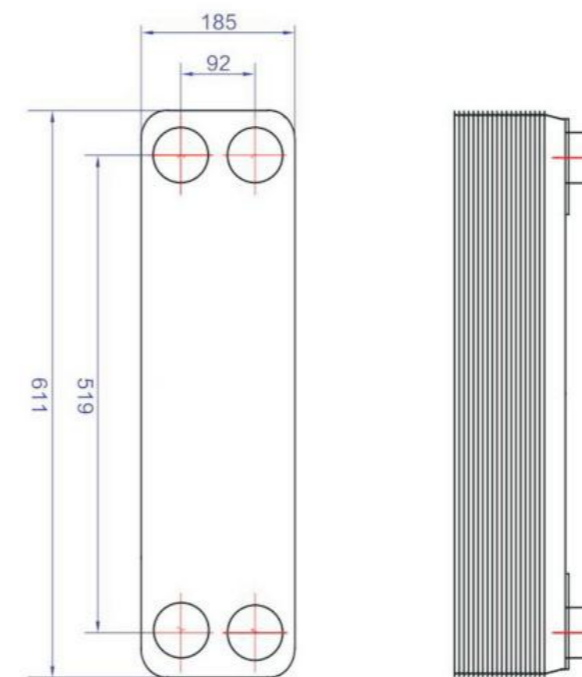

(N is the number of plates)

| | |
|---|-----------|
| Single piece heat exchange area (m ²) | 0.11 |
| Design Pressure (Mpa) | 3.0/4.5 |
| Test pressure (Mpa) | 4.5/6.5 |
| Power range (mm) | 11+2.4N |
| Effective heat transfer area (m ²) | 0.11(N-2) |
| Design temperature (°C) | -100/+200 |
| Channel Type | D、X、H |
| Optional materials for plates | 304、316L |
| Maximum number of assembled pieces | 250 |
| Maximum interface | DN50 |

Note: Non-standard interface, please contact our technical department.

Brazed plate heat exchanger

B3-120 Models

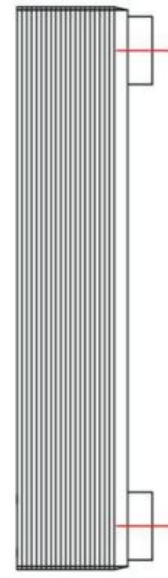
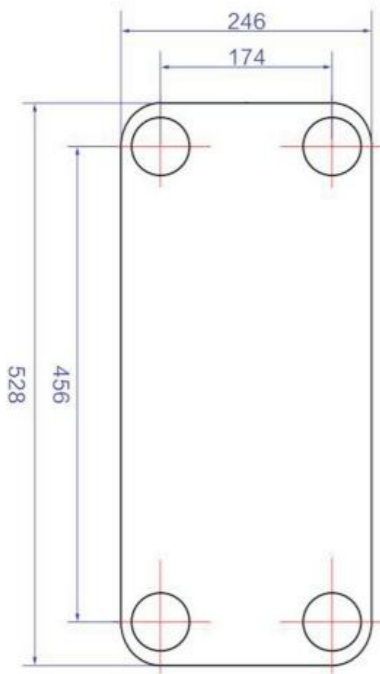

(N is the number of plates)

| | |
|---|-----------|
| Single piece heat exchange area (m ²) | 0.12 |
| Design Pressure (Mpa) | 3.0/4.5 |
| Test pressure (Mpa) | 4.5/6.5 |
| Power range (mm) | 13+2.38N |
| Effective heat transfer area (m ²) | 0.12(N-2) |
| Design temperature (°C) | -100/+200 |
| Channel Type | D |
| Optional materials for plates | 304, 316L |
| Maximum number of assembled pieces | 240 |
| Maximum interface | DN50 |

Note: Non-standard interface, please contact our technical department.

B3-190 Models

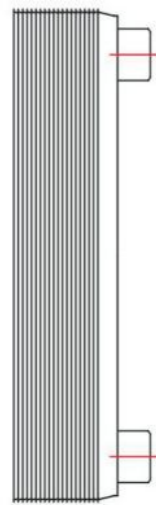
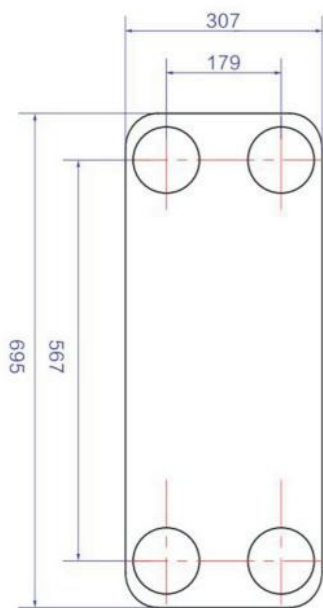

(N is the number of plates)

| | |
|---|-----------|
| Single piece heat exchange area (m ²) | 0.19 |
| Design Pressure (Mpa) | 3.0/4.5 |
| Test pressure (Mpa) | 4.5/6.5 |
| Power range (mm) | 12.5+2.6N |
| Effective heat transfer area (m ²) | 0.19(N-2) |
| Design temperature (°C) | -100/+200 |
| Channel Type | D |
| Optional materials for plates | 304, 316L |
| Maximum number of assembled pieces | 240 |
| Maximum interface | DN80 |

Note: Non-standard interface, please contact our technical department.

Brazed plate heat exchanger

B3-190X Models

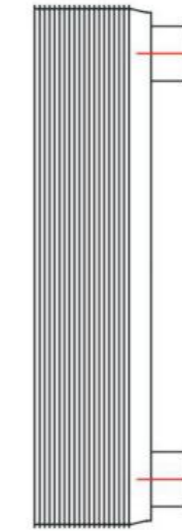
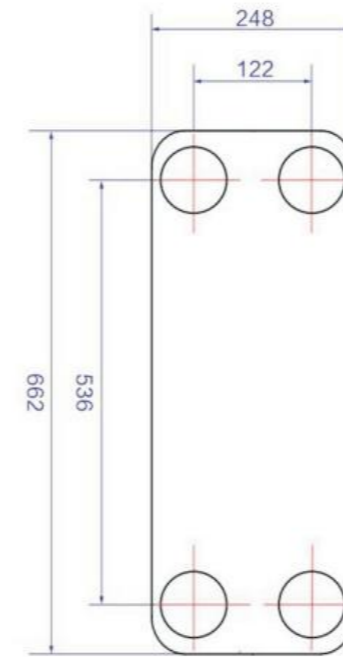

(N is the number of plates)

| | |
|---|-----------|
| Single piece heat exchange area (m ²) | 0.19 |
| Design Pressure (Mpa) | 3.0/4.5 |
| Test pressure (Mpa) | 4.5/6.5 |
| Power range (mm) | 13+2.7N |
| Effective heat transfer area (m ²) | 0.19(N-2) |
| Design temperature (°C) | -100/+200 |
| Channel Type | D |
| Optional materials for plates | 304, 316L |
| Maximum number of assembled pieces | 240 |
| Maximum interface | DN80 |

Note: Non-standard interface, please contact our technical department.

B3-200 Models

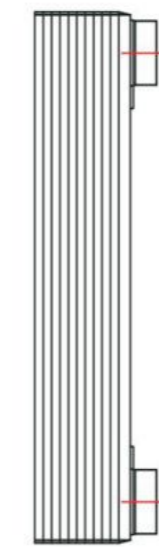
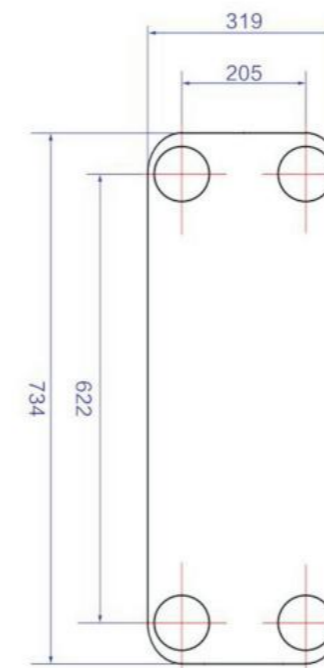

(N is the number of plates)

| | |
|---|------------|
| Single piece heat exchange area (m ²) | 0.2 |
| Design Pressure (Mpa) | 3.0/4.5 |
| Test pressure (Mpa) | 4.5/6.5 |
| Power range (mm) | 12.5+2.8N |
| Effective heat transfer area (m ²) | 0.2(N-2) |
| Design temperature (°C) | -100/+200 |
| Channel Type | D, X, H |
| Optional materials for plates | 304, 316L |
| Maximum number of assembled pieces | 240 |
| Maximum interface | Dn80/DN100 |

Note: Non-standard interface, please contact our technical department.

Brazed plate heat exchanger

B3-300 Models

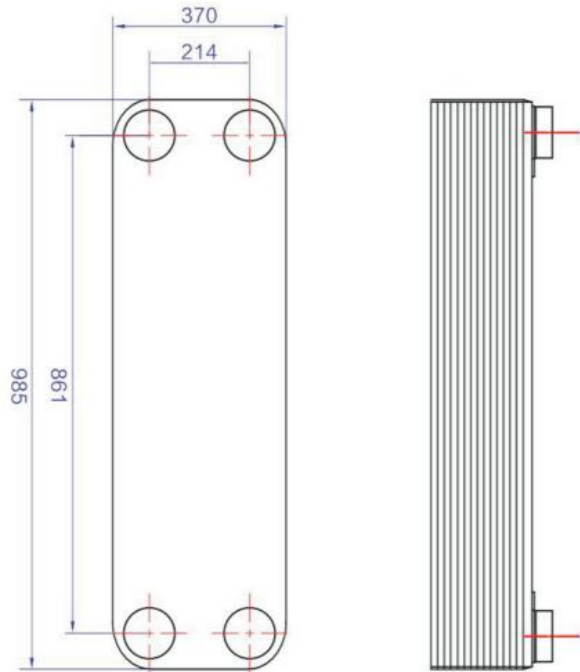

(N is the number of plates)

| | |
|---|-----------|
| Single piece heat exchange area (m ²) | 0.3 |
| Design Pressure (Mpa) | 1.5/3.0 |
| Test pressure (Mpa) | 2.0/4.5 |
| Power range (mm) | 13+2.75N |
| Effective heat transfer area (m ²) | 0.3(N-2) |
| Design temperature (°C) | -100/+200 |
| Channel Type | D |
| Optional materials for plates | 304, 316L |
| Maximum number of assembled pieces | 250 |
| Maximum interface | DN100 |

Note: Non-standard interface, please contact our technical department.

Brazed plate heat exchanger

B3-100 Models

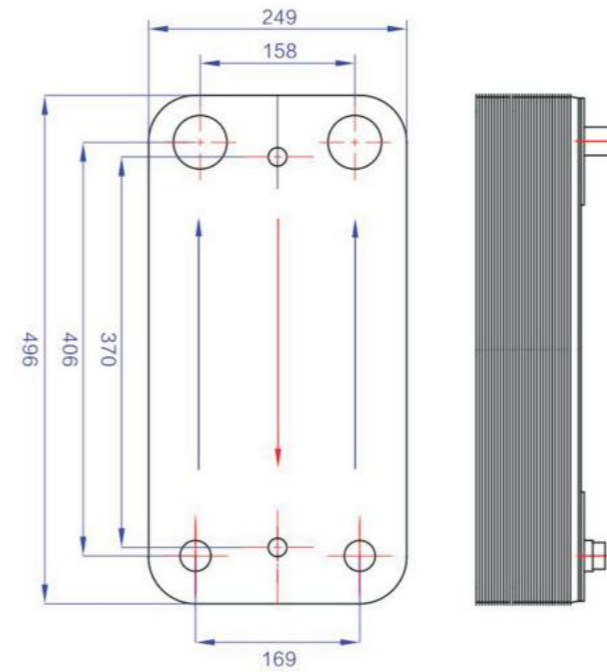

(N is the number of plates)

| | |
|---|-----------|
| Single piece heat exchange area (m ²) | 0.1 |
| Design Pressure (Mpa) | 3.0/4.5 |
| Test pressure (Mpa) | 4.5/6.5 |
| Power range (mm) | 10+2.15N |
| Effective heat transfer area (m ²) | 0.1(N-2) |
| Design temperature (°C) | -100/+200 |
| Channel Type | D |
| Optional materials for plates | 304, 316L |
| Maximum number of assembled pieces | 250 |
| Maximum interface | DN50 |

Note: Non-standard interface, please contact our technical department.

B3-600 Models

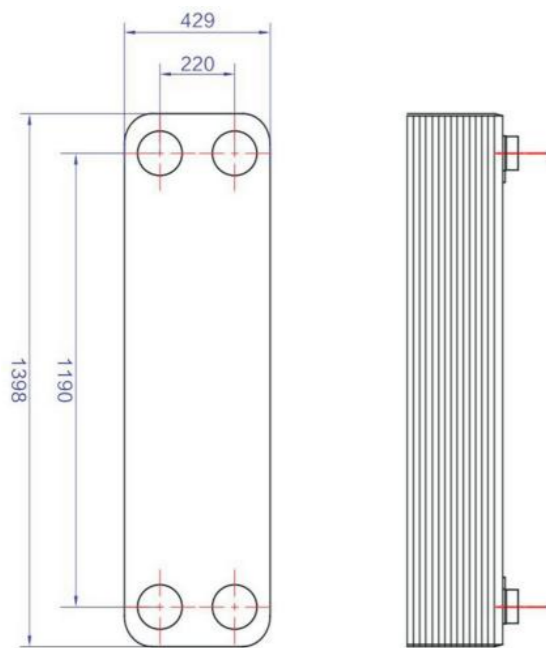

(N is the number of plates)

| | |
|---|-----------|
| Single piece heat exchange area (m ²) | 0.6 |
| Design Pressure (Mpa) | 1.5/3.0 |
| Test pressure (Mpa) | 2.0/4.5 |
| Power range (mm) | 22+2.78N |
| Effective heat transfer area (m ²) | 0.6(N-2) |
| Design temperature (°C) | -100/+200 |
| Channel Type | D |
| Optional materials for plates | 304, 316L |
| Maximum number of assembled pieces | 280 |
| Maximum interface | DN125 |

Note: Non-standard interface, please contact our technical department.

B3-100D Models

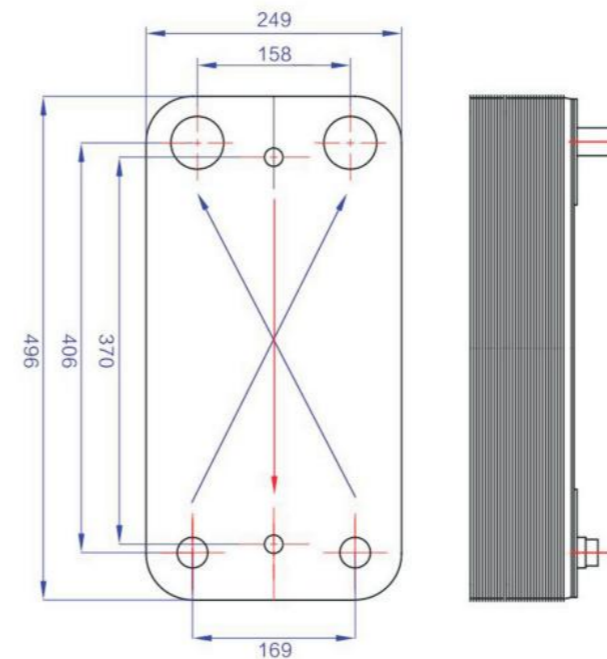

(N is the number of plates)

| | |
|---|-----------|
| Single piece heat exchange area (m ²) | 0.1 |
| Design Pressure (Mpa) | 3.0/4.5 |
| Test pressure (Mpa) | 4.5/6.5 |
| Power range (mm) | 10+2.15N |
| Effective heat transfer area (m ²) | 0.1(N-2) |
| Design temperature (°C) | -100/+200 |
| Channel Type | D, X, H |
| Optional materials for plates | 304, 316L |
| Maximum number of assembled pieces | 250 |
| Maximum interface | DN50 |

Note: Non-standard interface, please contact our technical department.

Brazed plate heat exchanger

B3-210 Models

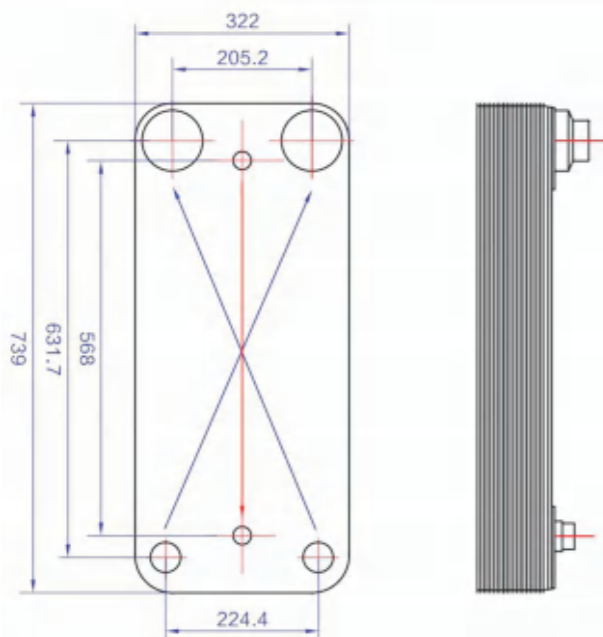

(N is the number of plates)

| | |
|---|-----------|
| Single piece heat exchange area (m ²) | 0.21 |
| Design Pressure (Mpa) | 3.0/4.5 |
| Test pressure (Mpa) | 4.5/6.5 |
| Power range (mm) | 13+2.55N |
| Effective heat transfer area (m ²) | 0.2(N-2) |
| Design temperature (°C) | -100/+200 |
| Channel Type | D |
| Optional materials for plates | 304, 316L |
| Maximum number of assembled pieces | 280 |
| Maximum interface | DN80 |

Note: Non-standard interface, please contact our technical department.

Brazed plate heat exchanger for cold dryer product model naming rules

CAD -XXX-XX+XX X-XX

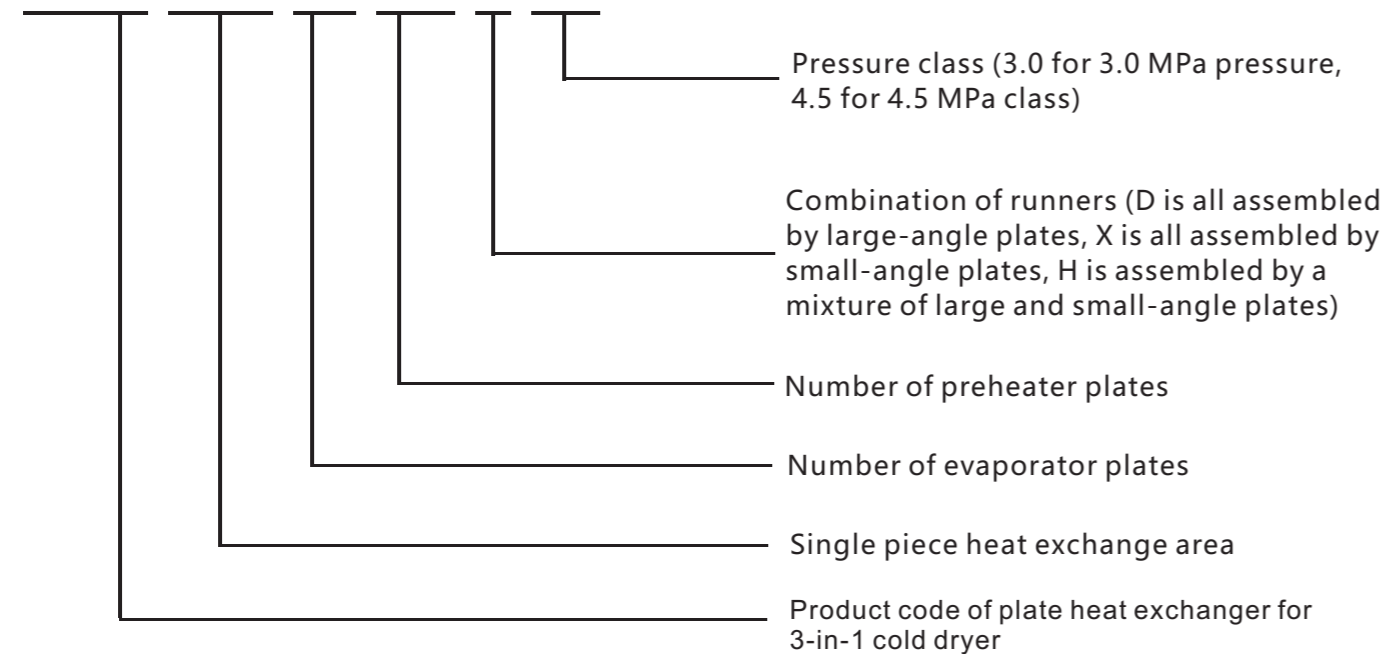

Brazed plate heat exchanger

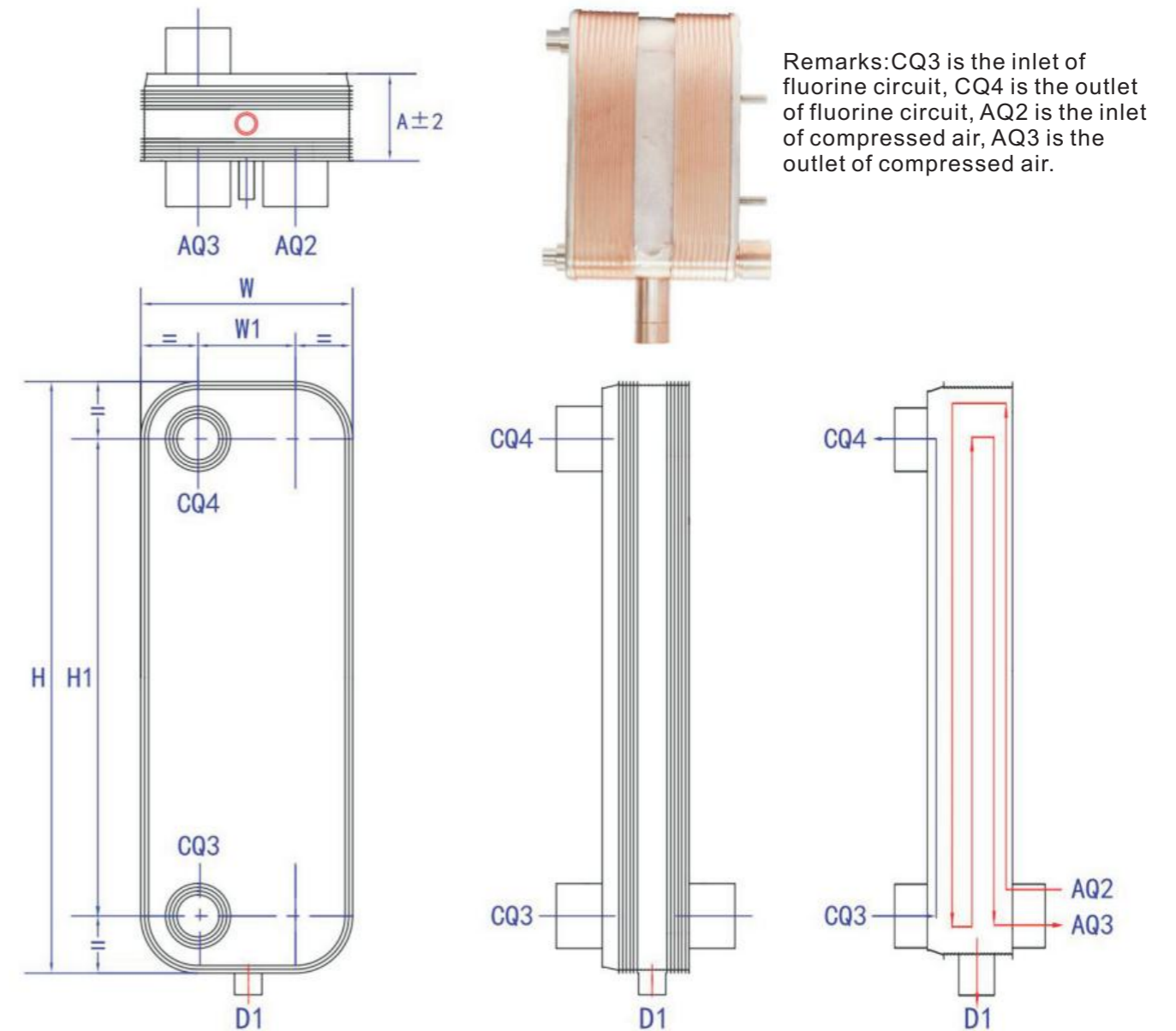

Product Parameter

| Models | H | H1 | W | W1 | Maximum interface |
|--------|-----|-----|-----|-----|-------------------|
| CAD014 | 206 | 172 | 76 | 42 | DN20 |
| CAD026 | 310 | 250 | 111 | 50 | DN32 |
| CAD095 | 616 | 519 | 191 | 92 | DN50 |
| CAD200 | 734 | 622 | 319 | 205 | DN100 |

Detachable plate heat exchanger

Customized products are available upon request



HYBR Series plate heat exchanger

Plate Material

| Plate Material | Scope of application |
|--|---|
| SUS304, 304L, 316, 316L | Water, river water, oil |
| Mantle Plate, Platinum Plate, Mantle Alloy | Sea water, salt water, saline substances |
| Hastelloy HASTELLOY(C276 , D205, B2G) | Concentrated sulphuric acid, hydrochloric acid, phosphoric acid |
| 20GR, 18N, 6MO(SMO254), Nickel(NI) | Dilute sulphuric acid, inorganic aqueous solution, dilute chemical aqueous solution, high temperature, high concentration of caustic soda |

The specifications and models of HYBR type plate heat exchanger are indicated as follows.:

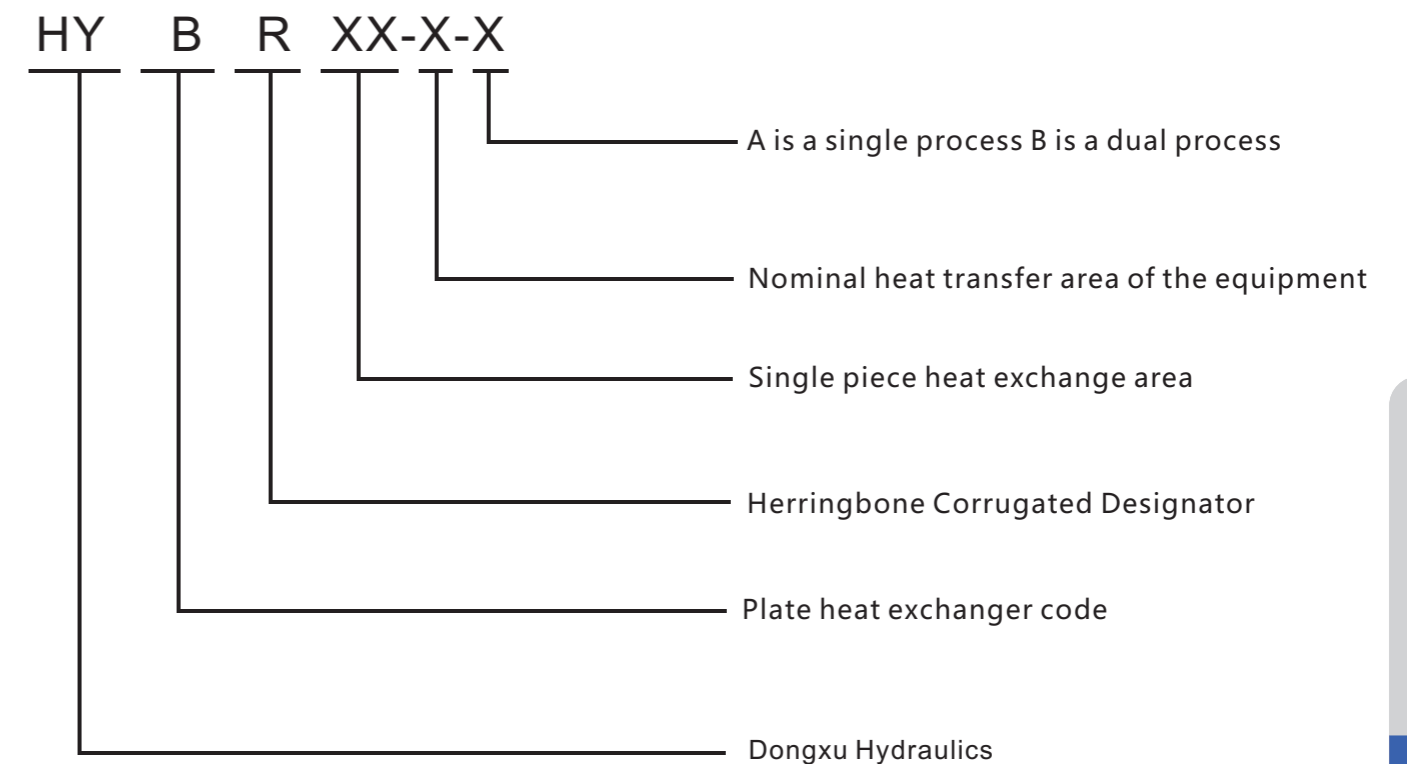
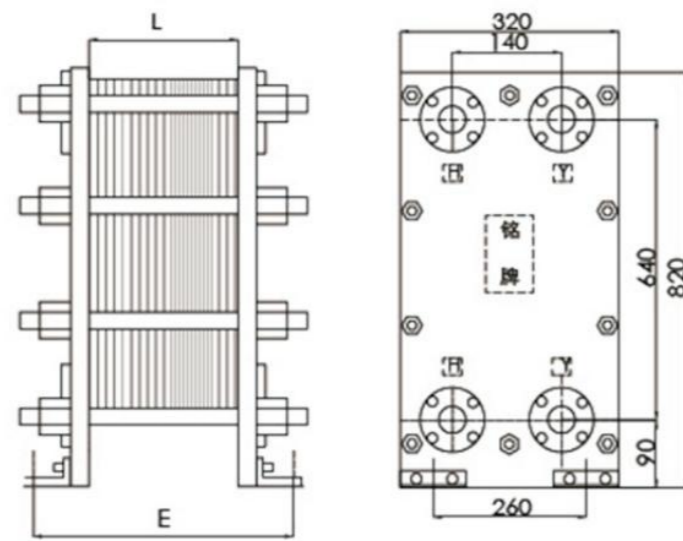

Plate heat exchanger

HYBR0.15 Models

| Models | HYBR0.15-xm ² -A single flow-B double flow |
|----------------------------------|---|
| Effective area of a single piece | 0.15m ² |
| Depth of plate corrugation | 3.6mm |
| Plate thickness | 0.5mm~0.6mm~0.8mm |
| Maximum flow rate | 42m ³ /h |
| Connection calibre | Dn40 Dn50 |
| Work pressure | 0.6Mpa 1.0Mpa 1.6Mpa |
| Plate Material | 304 316 316L |
| Sealing gasket | Nitrile Rubber NBR EPDM Fluoroelastomer |



| Models | Heat exchange area (m ²) | Number of plates | L | E | Weights (kg) | Flow rate (m ³ /h) |
|------------|--------------------------------------|------------------|---------|---------|--------------|-------------------------------|
| HYBR-0.15- | -3 | -20 | -76 | -190 | -132 | -10.5 |
| HYBR-0.15- | 4-5 | 28-33 | 105-125 | 219-239 | 140-150 | 13.5-16.9 |
| HYBR-0.15- | 6-7 | 40-46 | 152-174 | 266-288 | 160-170 | 20.2-23.6 |
| HYBR-0.15- | 8-9 | 53-60 | 201-228 | 315-342 | 180-190 | 27-30.4 |
| HYBR-0.15- | 10-12 | 66-80 | 250-304 | 364-418 | 200-210 | 33.8-40.5 |
| HYBR-0.15- | 14-15 | 93-100 | 353-380 | 467-494 | 220-230 | 47.3-50.7 |

Plate heat exchanger

HYBR0.2 Models

| Models | HYBR0.2-xm ² -A single flow-B double flow |
|----------------------------------|--|
| Effective area of a single piece | 0.2m ² |
| Depth of plate corrugation | 3.8mm |
| Plate thickness | 0.5mm~0.6mm~0.8mm |
| Maximum flow rate | 85m ³ /h |
| Connection calibre | Dn65 |
| Work pressure | 0.6Mpa 1.0Mpa 1.6Mpa |
| Plate Material | 304 316 316L |
| Sealing gasket | Nitrile Rubber NBR EPDM Fluoroelastomer |

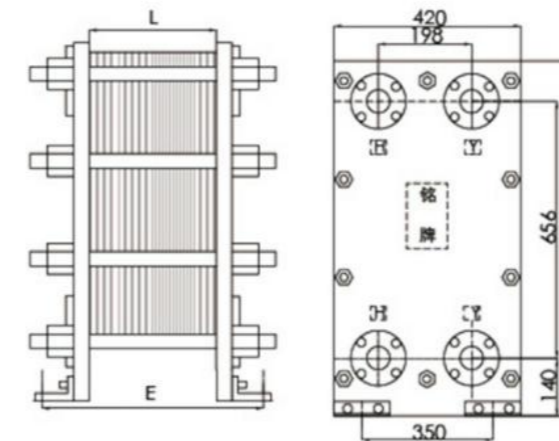

| Models | Heat exchange area (m ²) | Number of plates | L | E | Weights (kg) | Flow rate (m ³ /h) |
|-----------|--------------------------------------|------------------|---------|---------|--------------|-------------------------------|
| HYBR-0.2- | -5 | -25 | -98 | -228 | -190 | -17 |
| HYBR-0.2- | 6-7 | 30-35 | 120-140 | 250-270 | 207-213 | 20.4-23.8 |
| HYBR-0.2- | 8-10 | 40-50 | 160-200 | 290-330 | 220-240 | 27.2-34 |
| HYBR-0.2- | 12-15 | 60-75 | 240-300 | 370-430 | 260-280 | 40.8-51 |
| HYBR-0.2- | 16-18 | 80-90 | 320-360 | 450-490 | 290-310 | 54.4-61.2 |
| HYBR-0.2- | 20-24 | 100-120 | 400-480 | 530-610 | 330-360 | 68-81.6 |

Plate heat exchanger

HYBR0.25 Models

| Models | HYBR0.25-xm ² -A single flow-B double flow |
|----------------------------------|---|
| Effective area of a single piece | 0.25m ² |
| Depth of plate corrugation | 3.8mm |
| Plate thickness | 0.5mm~0.6mm~0.8mm |
| Maximum flow rate | 90m ³ /h |
| Connection calibre | Dn65 |
| Work pressure | 0.6Mpa 1.0Mpa 1.6Mpa |
| Plate Material | 304 316 316L |
| Sealing gasket | Nitrile Rubber NBR EPDM Fluoroelastomer |

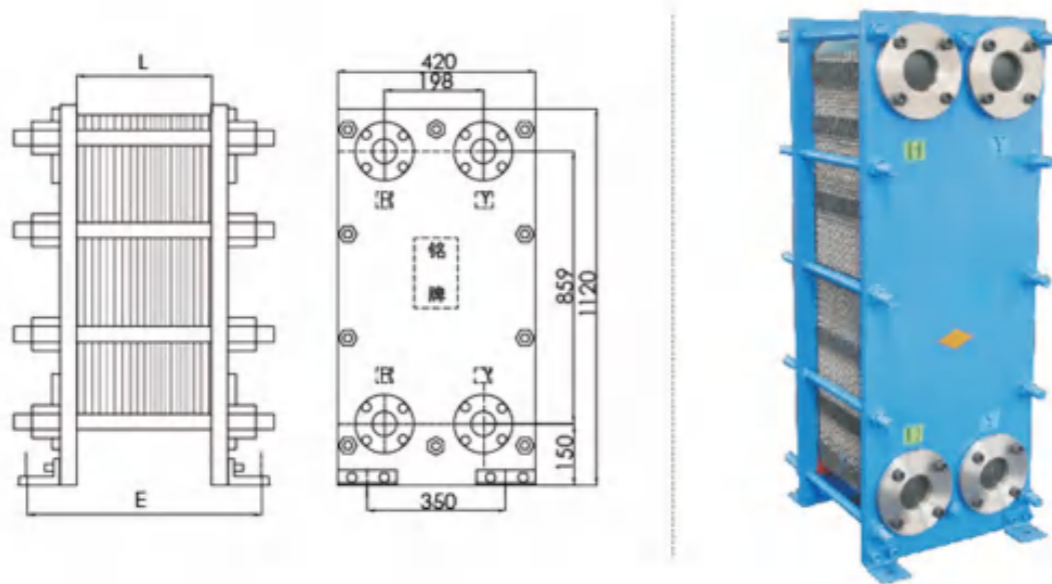

| Models | Heat exchange area (m ²) | Number of plates | L | E | Weights (kg) | Flow rate (m ³ /h) |
|------------|--------------------------------------|------------------|---------|---------|--------------|-------------------------------|
| HYBR-0.25- | -7 | -28 | -112 | -242 | -270 | -18 |
| HYBR-0.25- | 9-12 | 36-48 | 144-190 | 274-320 | 300-325 | 23-30.8 |
| HYBR-0.25- | 14-16 | 56-64 | 224-256 | 354-386 | 320-340 | 36-42 |
| HYBR-0.25- | 18-20 | 72-80 | 286-320 | 415-450 | 370-385 | 46-52 |
| HYBR-0.25- | 24-26 | 9-104 | 382-415 | 510-545 | 410-430 | 62-66 |
| HYBR-0.25- | 28-30 | 112-120 | 445-480 | 575-610 | 470-510 | 72-77 |

Plate heat exchanger

HYBR0.3 Models

| Models | HYBR0.3-xm ² -A single flow-B double flow |
|----------------------------------|--|
| Effective area of a single piece | 0.3m ² |
| Depth of plate corrugation | 3.85mm |
| Plate thickness | 0.5mm~0.6mm~0.8mm |
| Maximum flow rate | 120m ³ /h |
| Connection calibre | Dn80 |
| Work pressure | 0.6Mpa 1.0Mpa 1.6Mpa |
| Plate Material | 304 316 316L |
| Sealing gasket | Nitrile Rubber NBR EPDM Fluoroelastomer |

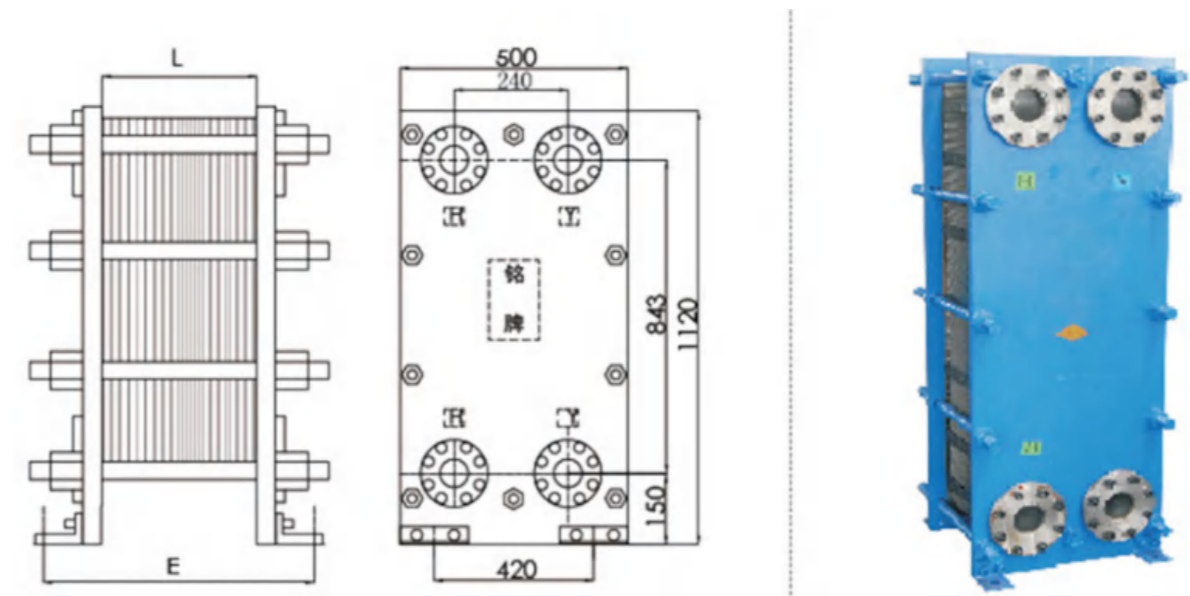

| Models | Heat exchange area (m ²) | Number of plates | L | E | Weights (kg) | Flow rate (m ³ /h) |
|-----------|--------------------------------------|------------------|---------|---------|--------------|-------------------------------|
| HYBR-0.3- | -14 | -25 | -98 | -228 | -190 | -17 |
| HYBR-0.3- | 16-18 | 30-35 | 120-140 | 250-270 | 207-213 | 20.4-23.8 |
| HYBR-0.3- | 20-22 | 40-50 | 160-200 | 290-330 | 220-240 | 27.2-34 |
| HYBR-0.3- | 24-26 | 60-75 | 240-300 | 370-430 | 260-280 | 40.8-51 |
| HYBR-0.3- | 16-18 | 80-90 | 320-360 | 450-490 | 290-310 | 54.4-61.2 |
| HYBR-0.3- | 20-24 | 100-120 | 400-480 | 530-610 | 330-360 | 68-81.6 |

Plate heat exchanger

HYBR0.35 Models

| | |
|----------------------------------|---|
| Models | HYBR0.35-xm ² -A single flow-B double flow |
| Effective area of a single piece | 0.35m ² |
| Depth of plate corrugation | 3.8mm |
| Plate thickness | 0.5mm~0.6mm~0.8mm |
| Maximum flow rate | 126m ³ /h |
| Connection calibre | Dn80 |
| Work pressure | 0.6Mpa 1.0Mpa 1.6Mpa |
| Plate Material | 304 316 316L |
| Sealing gasket | Nitrile Rubber NBR EPDM Fluoroelastomer |

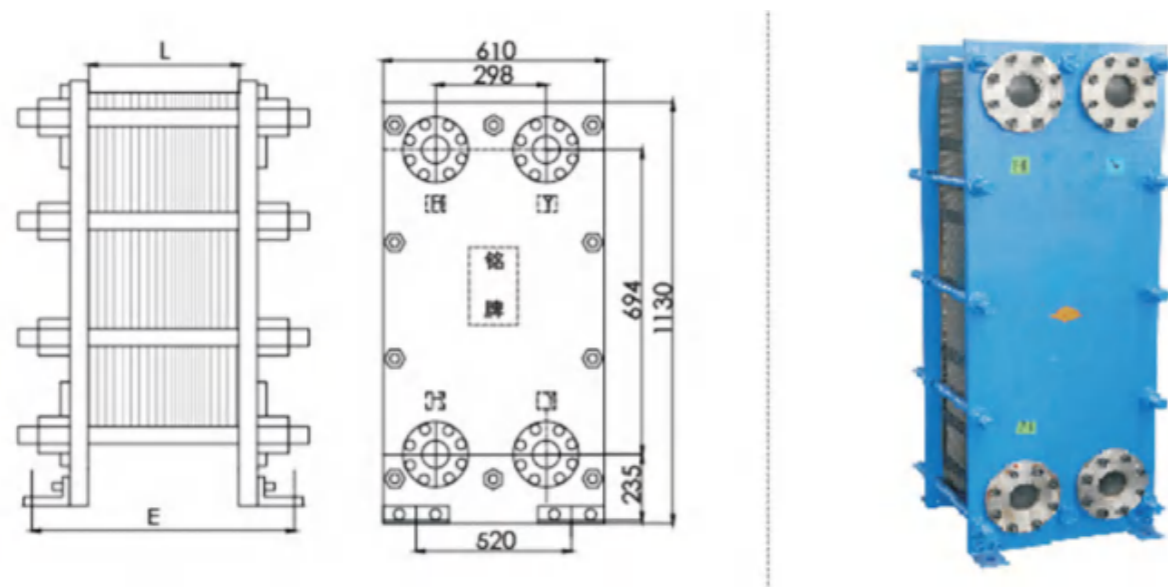

| Models | Heat exchange area (m ²) | Number of plates | L | E | Weights (kg) | Flow rate (m ³ /h) |
|------------|--------------------------------------|------------------|---------|---------|--------------|-------------------------------|
| HYBR-0.35- | -20 | -57 | -238 | -390 | -520 | -48 |
| HYBR-0.35- | 22-24 | 63-68 | 264-285 | 420-440 | 530-550 | 53-58 |
| HYBR-0.35- | 25-26 | 71-74 | 298-310 | 450-460 | 560-570 | 60-64 |
| HYBR-0.35- | 28-30 | 80-85 | 335-355 | 490-510 | 580-590 | 67-73 |
| HYBR-0.35- | 35-40 | 100-114 | 420-475 | 570-630 | 640-680 | 85-96 |
| HYBR-0.35- | 45-50 | 128-142 | 535-595 | 690-750 | 730-760 | 108-120 |

Plate heat exchanger

HYBR0.36 Models

| | |
|----------------------------------|---|
| Models | HYBR0.36-xm ² -A single flow-B double flow |
| Effective area of a single piece | 0.36m ² |
| Depth of plate corrugation | 3.8mm |
| Plate thickness | 0.5mm~0.6mm~0.8mm |
| Maximum flow rate | 126m ³ /h |
| Connection calibre | Dn80 |
| Work pressure | 0.6Mpa 1.0Mpa 1.6Mpa |
| Plate Material | 304 316 316L |
| Sealing gasket | Nitrile Rubber NBR EPDM Fluoroelastomer |

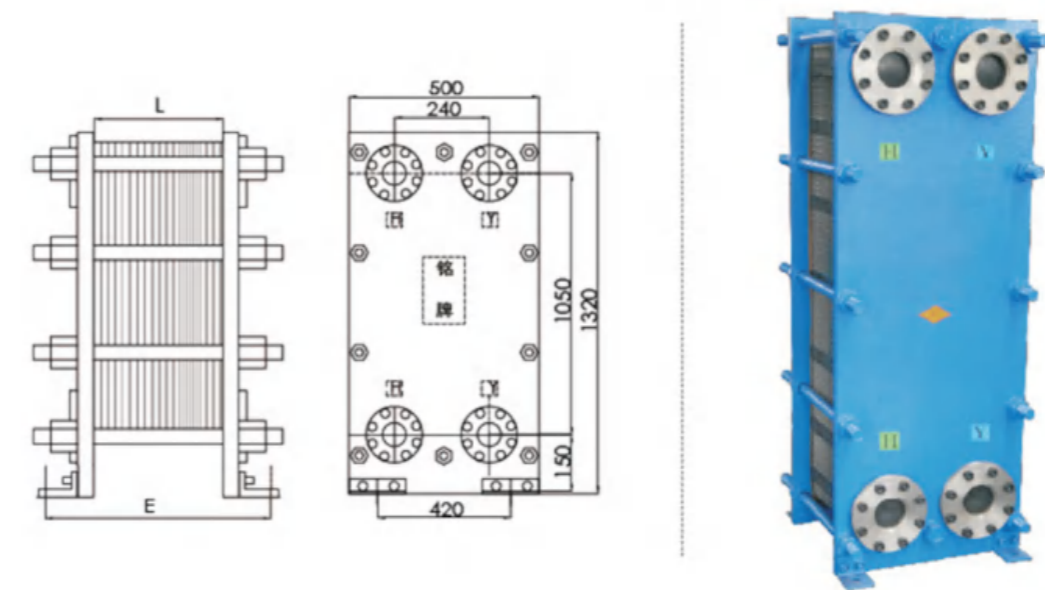

| Models | Heat exchange area (m ²) | Number of plates | L | E | Weights (kg) | Flow rate (m ³ /h) |
|------------|--------------------------------------|------------------|---------|---------|--------------|-------------------------------|
| HYBR-0.36- | -20 | -55 | -220 | -360 | -520 | -48 |
| HYBR-0.36- | 21-25 | 58-69 | 232-276 | 370-415 | 530-560 | 51-60 |
| HYBR-0.36- | 28-30 | 77-83 | 308-332 | 450-470 | 580-595 | 68-72 |
| HYBR-0.36- | 35-40 | 97-111 | 388-444 | 530-580 | 630-670 | 84-96 |
| HYBR-0.36- | 45-55 | 125-138 | 500-552 | 640-690 | 710-750 | 108-120 |
| HYBR-0.36- | 55-60 | 152-166 | 608-664 | 750-800 | 790-840 | 132-144 |

Plate heat exchanger

HYBR0.5 Models

| Models | HYBR0.5-xm ² -A single flow-B double flow |
|----------------------------------|--|
| Effective area of a single piece | 0.5m ² |
| Depth of plate corrugation | 3.85mm |
| Plate thickness | 0.6mm~0.8mm |
| Maximum flow rate | 203m ³ /h |
| Connection calibre | Dn150 |
| Work pressure | 0.6Mpa 1.0Mpa 1.6Mpa |
| Plate Material | 304 316 316L |
| Sealing gasket | Nitrile Rubber NBR EPDM Fluoroelastomer |

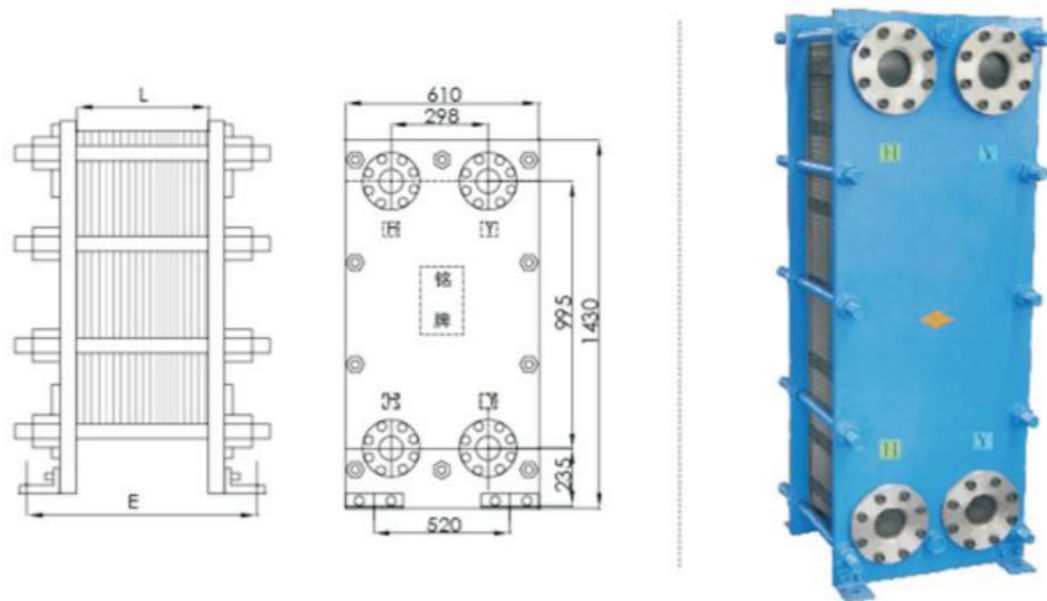

| Models | Heat exchange area (m ²) | Number of plates | L | E | Weights (kg) | Flow rate (m ³ /h) |
|-----------|--------------------------------------|------------------|---------|---------|--------------|-------------------------------|
| HYBR-0.5- | -35 | -70 | -294 | -450 | -960 | -78 |
| HYBR-0.5- | 40-45 | 80-90 | 335-378 | 490-530 | 1000-1044 | 90-102 |
| HYBR-0.5- | 50-55 | 100-110 | 420-460 | 570-610 | 1085-1126 | 112-124 |
| HYBR-0.5- | 60-65 | 120-130 | 504-545 | 660-700 | 1168-1210 | 135-146 |
| HYBR-0.5- | 70-75 | 140-150 | 585-630 | 740-785 | 1252-1294 | 158-168 |
| HYBR-0.5- | 80-85 | 160-170 | 670-710 | 820-860 | 1335-1377 | 180-192 |

Plate heat exchanger

HYBR0.7 Models

| Models | HYBR0.7-xm ² -A single flow-B double flow |
|----------------------------------|--|
| Effective area of a single piece | 0.7m ² |
| Depth of plate corrugation | 3.85mm |
| Plate thickness | 0.6mm~0.8mm |
| Maximum flow rate | 235m ³ /h |
| Connection calibre | Dn150 |
| Work pressure | 0.6Mpa 1.0Mpa 1.6Mpa |
| Plate Material | 304 316 316L |
| Sealing gasket | Nitrile Rubber NBR EPDM Fluoroelastomer |

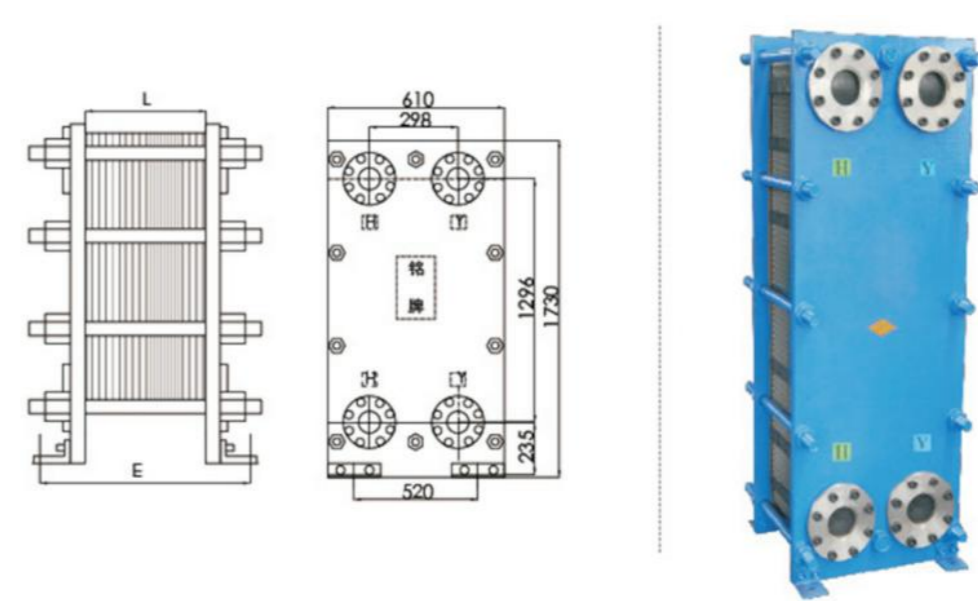

| Models | Heat exchange area (m ²) | Number of plates | L | E | Weights (kg) | Flow rate (m ³ /h) |
|-----------|--------------------------------------|------------------|---------|---------|--------------|-------------------------------|
| HYBR-0.7- | -55 | -84 | -350 | -510 | -1210 | -106 |
| HYBR-0.7- | 60-65 | 92-100 | 385-420 | 550-585 | 1250-1300 | 116-136 |
| HYBR-0.7- | 70-75 | 107-115 | 448-480 | 610-640 | 1340-1370 | 136-146 |
| HYBR-0.7- | 80-85 | 123-130 | 515-545 | 680-710 | 1430-1460 | 155-165 |
| HYBR-0.7- | 90-95 | 138-146 | 578-610 | 740-775 | 1500-1530 | 175-185 |
| HYBR-0.7- | 100-120 | 153-184 | 640-770 | 805-930 | 1600-1780 | 195-233 |

Plate heat exchanger

HYBR0.8 Models

| | |
|---|--|
| Models | HYBR0.8-xm ² -A single flow-B double flow |
| Effective area of a single piece | 0.82m ² |
| board spacing | 4mm |
| Single-circulation cross-sectional area | 0.00226m ² |
| Maximum processing capacity | 325m ³ /h |
| Flange passages | Dn200 |
| Operating temperature | ≤160°C |
| Work pressure | 0.6~1.0Mpa |
| Angle Hole Diameter | 210mm |

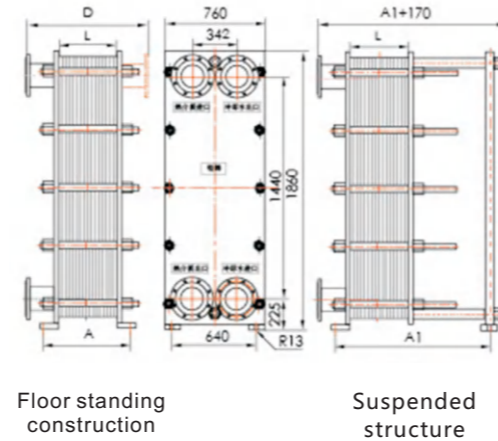

D: Flange spacing in case of double flow Interface flange spacing standard JB/T81-94
Water treatment capacity is calculated for a single process (flow rate between plates is 0.4m/s)

| Models | Total heat transfer area (m ²) | Plate book (sheet) | L(mm) | D | A | A1 | water treatment capacity (m ³ /h) | Weights (kg) |
|--------|--|--------------------|-------|------|------|------|--|--------------|
| 1 | 50 | 63 | 277 | 707 | 497 | 847 | 100 | 1062/1700 |
| 2 | 60 | 75 | 333 | 763 | 553 | 956 | 120 | 1705/1790 |
| 3 | 65 | 81 | 361 | 791 | 581 | 1011 | 131 | 1750/1835 |
| 4 | 70 | 89 | 396 | 826 | 616 | 1079 | 142 | 1790/1880 |
| 5 | 75 | 95 | 423 | 853 | 643 | 1131 | 153 | 1830/1930 |
| 6 | 80 | 101 | 450 | 880 | 670 | 1184 | 163 | 1875/1975 |
| 7 | 85 | 107 | 477 | 907 | 697 | 1236 | 173 | 1915/2020 |
| 8 | 90 | 113 | 502 | 932 | 722 | 1284 | 181 | 1975/2050 |
| 9 | 95 | 119 | 530 | 960 | 750 | 1339 | 192 | 2000/2110 |
| 10 | 100 | 125 | 558 | 988 | 778 | 1394 | 202 | 2060/2175 |
| 11 | 110 | 139 | 621 | 1051 | 841 | 1516 | 224 | 2140/2265 |
| 12 | 120 | 151 | 675 | 1105 | 895 | 1621 | 244 | 2140/2375 |
| 13 | 140 | 175 | 783 | 1213 | 1003 | 1831 | 283 | 2410/2560 |
| 14 | 150 | 189 | 846 | 1276 | 1066 | 1954 | 305 | 2495/2650 |
| 15 | 160 | 201 | 900 | 1330 | 1120 | 2059 | 325 | 2580/2740 |

Plate heat exchanger

HYBR1.0 Models

| | |
|---|--|
| Models | HYBR1.0-xm ² -A single flow-B double flow |
| Effective area of a single piece | 1.06m ² |
| board spacing | 3.3mm |
| Single-circulation cross-sectional area | 0.00254m ² |
| Maximum processing capacity | 421m ³ /h |
| Flange passages | Dn225 |
| Operating temperature | ≤160°C |
| Work pressure | 0.6~1.0Mpa |
| Angle Hole Diameter | 230mm |

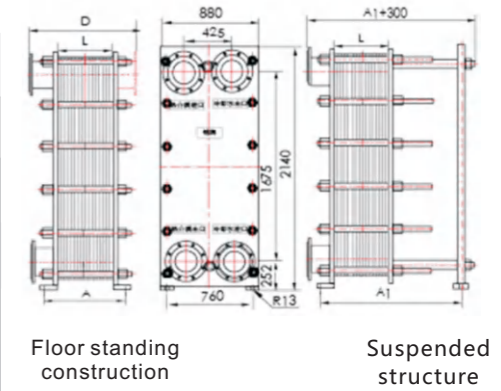

D: Flange spacing in case of double flow Interface flange spacing standard JB/T81-94
Water treatment capacity is calculated for a single process (flow rate between plates is 0.4m/s)

| Models | Total heat transfer area (m ²) | Plate book (sheet) | L(mm) | D | A | A1 | water treatment capacity (m ³ /h) | Weights (kg) |
|--------|--|--------------------|-------|------|------|------|--|--------------|
| 1 | 70 | 71 | 270 | 730 | 490 | 995 | 128 | 2318/2412 |
| 2 | 80 | 81 | 308 | 770 | 528 | 1055 | 146 | 2412/2513 |
| 3 | 90 | 91 | 342 | 802 | 562 | 1130 | 165 | 2505/2617 |
| 4 | 100 | 101 | 384 | 845 | 604 | 1195 | 183 | 2600/2778 |
| 5 | 110 | 111 | 418 | 880 | 638 | 1270 | 201 | 2690/2822 |
| 6 | 120 | 121 | 460 | 920 | 680 | 1330 | 219 | 2787/2922 |
| 7 | 140 | 141 | 536 | 995 | 756 | 1470 | 256 | 2974/3128 |
| 8 | 150 | 151 | 574 | 1035 | 794 | 1545 | 274 | 3067/3232 |
| 9 | 160 | 161 | 612 | 1070 | 832 | 1605 | 293 | 3160/3336 |
| 10 | 180 | 181 | 688 | 1150 | 908 | 1745 | 329 | 3348/3538 |
| 11 | 200 | 201 | 764 | 1225 | 984 | 1885 | 366 | 3535/3742 |
| 12 | 210 | 211 | 802 | 1260 | 1022 | 1955 | 384 | 3628/3845 |
| 13 | 220 | 221 | 840 | 1300 | 1060 | 2020 | 402 | 3722/3947 |
| 14 | 230 | 231 | 878 | 1340 | 1098 | 2095 | 421 | 3815/4050 |

Plate heat exchanger

HYBR1.3 Models

| Models | HYBR1.3-xm ² -A single flow-B double flow |
|---|--|
| Effective area of a single piece | 1.304m ² |
| board spacing | 3.5mm |
| Single-circulation cross-sectional area | 0.00288m ² |
| Maximum processing capacity | 476m ³ /h |
| Flange passages | Dn250 |
| Operating temperature | ≤160°C |
| Work pressure | 0.6~1.0Mpa |
| Angle Hole Diameter | 260mm |

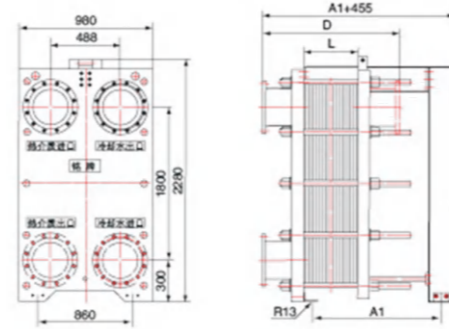

D: Flange spacing in case of double flow Interface flange spacing standard JB/T81-94
Water treatment capacity is calculated for a single process (flow rate between plates is 0.4m/s)

| Models | Total heat transfer area (m ²) | Plate book (sheet) | L(mm) | D | A1 | water treatment capacity (m ³ /h) | Weights (kg) |
|--------|--|--------------------|-------|------|------|--|--------------|
| 1 | 100 | 77 | 312 | 902 | 1000 | 157 | 3035 |
| 2 | 110 | 85 | 344 | 934 | 1065 | 173 | 3120 |
| 3 | 120 | 93 | 377 | 967 | 1125 | 191 | 3208 |
| 4 | 130 | 101 | 410 | 1000 | 1190 | 207 | 3392 |
| 5 | 140 | 107 | 435 | 1025 | 1235 | 223 | 3355 |
| 6 | 150 | 115 | 467 | 1057 | 1300 | 237 | 3445 |
| 7 | 180 | 139 | 566 | 1156 | 1485 | 287 | 3704 |
| 8 | 200 | 153 | 623 | 1213 | 1595 | 319 | 3855 |
| 9 | 220 | 169 | 689 | 1279 | 1720 | 349 | 4025 |
| 10 | 250 | 193 | 787 | 1377 | 1905 | 399 | 4287 |
| 11 | 300 | 231 | 943 | 1533 | 2200 | 476 | 4697 |

Plate heat exchanger

HYBR1.6 Models

| Models | HYBR1.6-xm ² -A single flow-B double flow |
|---|--|
| Effective area of a single piece | 1.6m ² |
| board spacing | 3.5mm |
| Single-circulation cross-sectional area | 0.00328m ² |
| Maximum processing capacity | 590m ³ /h |
| Flange passages | Dn300 |
| Operating temperature | ≤160°C |
| Work pressure | 0.6~1.0Mpa |
| Angle Hole Diameter | 310mm |

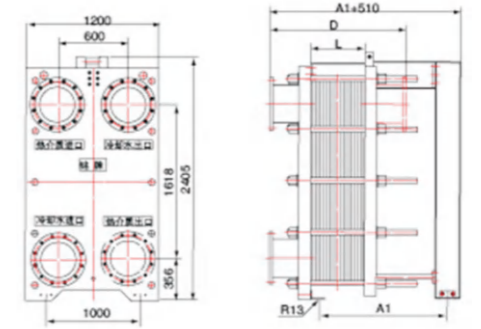

D: Flange spacing in case of double flow Interface flange spacing standard JB/T81-94
Water treatment capacity is calculated for a single process (flow rate between plates is 0.4m/s)

| Models | Total heat transfer area (m ²) | Plate book (sheet) | L(mm) | D | A1 | water treatment capacity (m ³ /h) | Weights (kg) |
|--------|--|--------------------|-------|------|------|--|--------------|
| 1 | 120 | 75 | 303 | 1003 | 1007 | 175 | 4635 |
| 2 | 130 | 81 | 329 | 1029 | 1049 | 190 | 4742 |
| 3 | 140 | 89 | 359 | 1059 | 1097 | 207 | 4852 |
| 4 | 150 | 95 | 384 | 1084 | 1138 | 221 | 4903 |
| 5 | 180 | 113 | 457 | 1157 | 1256 | 263 | 5172 |
| 6 | 200 | 125 | 508 | 1208 | 1339 | 293 | 5334 |
| 7 | 225 | 141 | 572 | 1272 | 1442 | 330 | 5547 |
| 8 | 250 | 157 | 641 | 1341 | 1553 | 369 | 5764 |
| 9 | 300 | 189 | 769 | 1469 | 1760 | 443 | 6165 |
| 10 | 350 | 219 | 893 | 1593 | 1960 | 514 | 6595 |
| 11 | 400 | 251 | 1025 | 1725 | 2174 | 590 | 7000 |